



# *Sistemi di scarico*

---

WASTE SYSTEMS

ABFLUSSSYSTEME

SYSTÈMES DE EVACUATION

SISTEMAS DE EVACUACIÓN

## Raccorderie Metalliche **Drain**

RM DRAIN è un sistema di scarico composto da elementi tubiformi e raccordi in acciaio inossidabile AISI 316L (1.4404) a parete sottile, particolarmente adatto per convogliare, sia a gravità che sottovuoto, acque reflue frequentemente contaminate da sostanze organiche e chimiche corrosive. Il vasto assortimento dei componenti è disponibile in sette dimensioni, dal DN 40 al DN 150 (DN 200 in fase di realizzazione). Grazie alla loro elevata resistenza al fuoco (Certificati Classe A, non combustibili), consente di soddisfare molteplici installazioni, in particolare quelle in ambito navale (navi da crociera, navi militari, yacht, strutture offshore, ecc.).

RM DRAIN is a draining system consisting of tubes and joints in AISI 316L (1.4404) stainless steel, thin wall, suitable to convey, with gravity or under vacuum, waste waters which are frequently contaminated with organic or chemical corrosive substances. The wide range of products is available in seven sizes, DN 40 to DN 150 (DN 200 work in progress). As they are consistently fire resistant, (certified class A, not combustible), they allow to comply with many installation requirements as for marine installations (cruise ships, military ships, yacht, offshore structures, etc.).

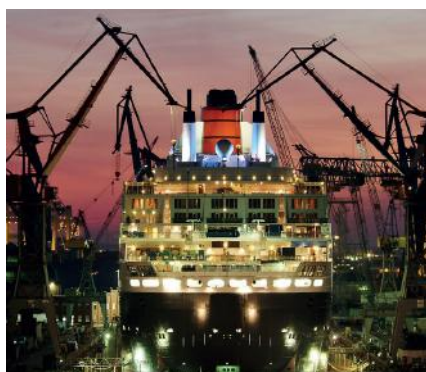



Il montaggio del sistema RM DRAIN richiede semplici e rapide operazioni manuali che non obbligano l'utilizzo di particolari e spesso costose attrezzature.

The RM DRAIN assembling procedure asks for simple and rapid manual operations, with no specific or expensive tool.



1

Verificare pulizia componenti / Verify the components' cleaning



2

Inserire guarnizione nel bicchiere / Insert the gasket into socket



3

Verificare posizionamento guarnizione / Verify the correct gasket's position



4

Marcatura quota d'innesto / Marking the insertion's depth



5

Lubrificazione zona interna guarnizione / Internal gasket lubrication



6

Inserimento tubo nel raccordo / Inserting of the pipe into the fitting



7











Pulizia di eventuale grasso residuo / Cleaning of the grease residual



8

Controllo completo inserimento del tubo nel bicchiere / Check of complete pipe's insertion into the fitting

## Certificazioni / Certifications

		PIPES AND FITTINGS FOR VACUUM AND GRAVITY DRAIN SYSTEM - RM DRAIN	LR2003327TA
		RM DRAIN TUBAZIONI DI SCARICO A GRAVITÀ E VUOTO RM DRAINING SYSTEMS - GRAVITY AND VACUUM	MAC - 412019CS / 001 - 002
		PIPES AND FITTINGS FOR VACUUM AND GRAVITY DRAIN SYSTEM - RM DRAIN	TAP000017F
		PIPE, DUCT, TRUNK - RM DRAIN	MEDB00007F2
		DRAINING SYSTEM	POCC IT.31588.040ЦH0.0C05.00356

## FOCUS ON

### DIMENSIONI DEL BICCHIERE / SOCKET SIZE

DN	D mm	S mm	D1 mm	D2 mm	D3 mm	P mm
DN 40	42	1	45	48	45	30
DN 50	53	1	56	60	56	38
DN 65	73	1,25	76	81	76	55
DN 80	88,9	1,25	92	99	92	60
DN 100	102	1,25	106	114	107	70
DN 125	133	1,5	138	147	140	75
DN 150	159	1,5	164	176	168	80

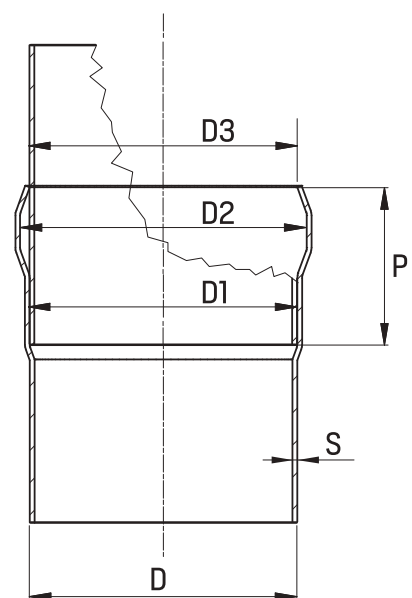

**B 100 101**
**802**
**TUBO CON UN BICCHIERE**

- PIPE WITH ONE SOCKET
- ROHR MIT EINER MUFFE
- TUYAU AVEC UNE EMBOITURE
- TUBO CON UN MANGUITO

**MATERIAL:** AISI 316L – 1.4404  
**GASKET:** EPDM cod. 826/GV (Ø 40 ÷ 65)  
 EPDM cod. 826/G (Ø 80 ÷ 150)  
**NORM:** EN 1124-3

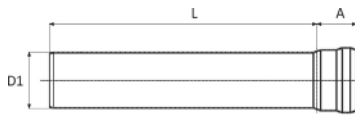



CODE	DN	D1 mm	L mm	A mm			€
802040025	40	42	250	30	0,295	1	24,43
802040050		42	500	30	0,550	1	32,79
802040075		42	750	30	0,810	1	43,65
802040100		42	1000	30	1,065	1	50,79
802040150		42	1500	30	1,580	1	72,19
802040200		42	2000	30	2,100	1	90,98
802040250		42	2500	30	2,610	1	113,69
802040300		42	3000	30	3,120	1	132,59
802050025	50	53	250	38	0,385	1	25,92
802050050		53	500	38	0,710	1	37,32
802050075		53	750	38	1,040	1	52,19
802050100		53	1000	38	1,365	1	60,98
802050150		53	1500	38	2,020	1	86,81
802050200		53	2000	38	2,670	1	113,04
802050250		53	2500	38	3,320	1	134,90
802050300		53	3000	38	3,970	1	163,28
802065025	65	73	250	55	0,710	1	37,54
802065050		73	500	55	1,270	1	57,35
802065075		73	750	55	1,850	1	83,01
802065100		73	1000	55	2,400	1	95,24
802065150		73	1500	55	3,550	1	133,09
802065200		73	2000	55	4,650	1	174,66
802065250		73	2500	55	5,800	1	212,00
802065300		73	3000	55	6,900	1	254,89
802080025	80	88,9	250	60	0,875	1	47,91
802080050		88,9	500	60	1,600	1	76,66
802080075		88,9	750	60	2,250	1	101,23
802080100		88,9	1000	60	2,950	1	117,79
802080150		88,9	1500	60	4,320	1	167,14
802080200		88,9	2000	60	5,700	1	217,77
802080250		88,9	2500	60	7,700	1	264,87
802080300		88,9	3000	60	8,450	1	320,22
802100025	100	102	250	70	1,050	1	53,45
802100050		102	500	70	1,850	1	82,22
802100075		102	750	70	2,620	1	119,00
802100100		102	1000	70	3,400	1	133,87
802100150		102	1500	70	4,980	1	192,29
802100200		102	2000	70	6,550	1	249,06
802100250		102	2500	70	8,130	1	305,87
802100300		102	3000	70	9,700	1	371,58
802125025	125	133	250	75	1,650	1	95,79
802125050		133	500	75	2,885	1	167,29

B 100 101

**802****TUBO CON UN BICCHIERE**

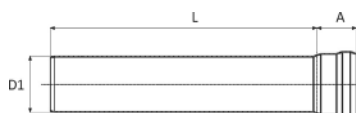
- PIPE WITH ONE SOCKET
- ROHR MIT EINER MUFFE
- TUYAU AVEC UNE EMBOITURE
- TUBO CON UN MANGUITO

**MATERIAL:** AISI 316L - 1.4404**GASKET:** EPDM cod. 826/GV (Ø 40 ÷ 65)  
EPDM cod. 826/G (Ø 80 ÷ 150)**NORM:** EN 1124-3



CODE	DN	D1 mm	L mm	A mm			€
802125075	125	133	750	75	4,125	1	230,13
802125100		133	1000	75	5,360	1	311,34
802125150		133	1500	75	7,830	1	435,59
802125200		133	2000	75	10,300	1	580,74
802125250		133	2500	75	12,775	1	707,48
802125300		133	3000	75	15,250	1	846,54
802150025	150	159	250	80	2,000	1	118,84
802150050		159	500	80	3,500	1	196,77
802150075		159	750	80	5,000	1	289,93
802150100		159	1000	80	6,450	1	372,00
802150150		159	1500	80	9,400	1	552,03
802150200		159	2000	80	12,400	1	711,41
802150250		159	2500	80	15,350	1	866,64
802150300		159	3000	80	18,300	1	1037,04

B 100 101

**803****TUBO CON DUE BICCHIERI**

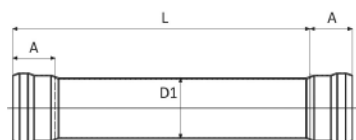
- PIPE WITH TWO SOCKETS
- ROHR MIT ZWEI MUFFEN
- TUYAU AVEC DEUX EMBOITURES
- TUBO CON DOS MANGUITOS

**MATERIAL:** AISI 316L - 1.4404**GASKET:** EPDM cod. 826/GV (Ø 40 ÷ 65)  
EPDM cod. 826/G (Ø 80 ÷ 150)**NORM:** EN 1124-3

CODE	DN	D1 mm	L mm	A mm			€	
8030400250	40	42	250	30	0,330	1	38,57	
8030400500		42	500	30	0,580	1	47,73	
8030400750		42	750	30	0,860	1	59,28	
8030401000		42	1000	30	1,100	1	64,05	
8030401500		42	1500	30	1,600	1	83,63	
8030402000		42	2000	30	2,150	1	102,06	
8030402500		42	2500	30	2,650	1	124,39	
8030403000		42	3000	30	3,150	1	139,93	
8030500250		50	53	250	38	0,420	1	44,84
8030500500			53	500	38	0,755	1	51,92
8030500750	53		750	38	1,080	1	65,13	
8030501000	53		1000	38	1,400	1	76,66	
8030501500	53		1500	38	2,100	1	102,18	
8030502000	53		2000	38	2,700	1	126,84	
8030502500	53		2500	38	3,350	1	153,14	
8030503000	53		3000	38	4,010	1	177,52	

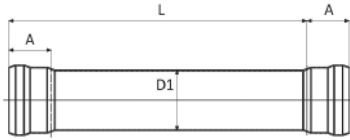

## 803

### TUBO CON DUE BICCHIERI

- PIPE WITH TWO SOCKETS
- ROHR MIT ZWEI MUFFEN
- TUYAU AVEC DEUX EMBOITURES
- TUBO CON DOS MANGUITOS

**MATERIAL:** AISI 316L – 1.4404

**GASKET:** EPDM cod. 826/GV (Ø 40 ÷ 65)  
EPDM cod. 826/G (Ø 80 ÷ 150)

**NORM:** EN 1124-3

CODE	DN	D1 mm	L mm	A mm			€
8030650250	65	73	250	55	0,760	1	50,77
8030650500		73	500	55	1,330	1	69,97
8030650750		73	750	55	1,880	1	91,39
8030651000		73	1000	55	2,450	1	110,64
8030651500		73	1500	55	3,560	1	151,39
8030652000		73	2000	55	4,700	1	189,68
8030652500		73	2500	55	5,820	1	228,46
8030653000		73	3000	55	6,950	1	269,95
8030800750	80	88,9	750	60	2,300	1	105,47
8030801000		88,9	1000	60	3,000	1	131,77
8030801500		88,9	1500	60	4,360	1	181,85
8030802000		88,9	2000	60	5,780	1	232,44
8030802500		88,9	2500	60	7,110	1	286,61
8030803000	88,9	3000	60	8,480	1	333,58	
8031000750	100	102	750	70	2,670	1	120,93
8031001000		102	1000	70	3,500	1	152,99
8031001500		102	1500	70	5,050	1	212,32
8031002000		102	2000	70	6,600	1	267,45
8031002500		102	2500	70	8,180	1	333,91
8031003000	102	3000	70	9,750	1	384,60	
8031250750	125	133	750	75	4,200	1	235,07
8031251000		133	1000	75	5,400	1	312,97
8031251500		133	1500	75	7,900	1	448,38
8031252000		133	2000	75	10,350	1	590,45
8031252500		133	2500	75	12,950	1	716,90
8031253000	133	3000	75	15,300	1	862,39	
8031500750	150	159	750	80	5,000	1	293,86
8031501000		159	1000	80	6,500	1	391,71
8031501500		159	1500	80	9,500	1	564,33
8031502000		159	2000	80	12,450	1	745,84
8031502500		159	2500	80	15,400	1	890,47
8031503000		159	3000	80	18,350	1	1075,33



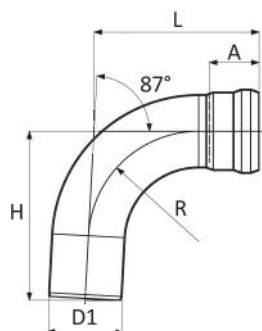

B 100 102

**804/87****CURVA 87°**

- ELBOW 87°
- ROHRBOGEN 87°
- COUDE 87°
- CURVA 87°

**MATERIAL:** AISI 316L - 1.4404**GASKET:** EPDM cod. 826/GV (Ø 40 ÷ 65)  
EPDM cod. 826/G (Ø 80)**NORM:** EN 1124-3

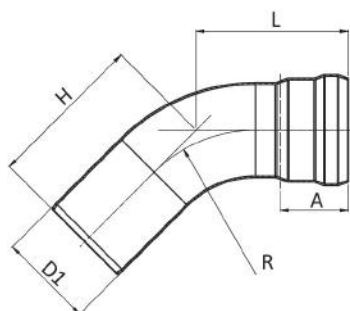

CODE	DN	D1 mm	L mm	A mm	H mm	R mm			€
804040087	40	42	102	30	105	63	0,193	1	24,70
804050087	50	53	130	38	133	80	0,310	1	30,50
804065087	65	73	172	55	176	110	0,700	1	57,71
804080087	80	88,9	199	60	204	133	1,180	1	76,59

**804/45****CURVA 45°**

- ELBOW 45°
- ROHRBOGEN 45°
- COUDE 45°
- CURVA 45°

**MATERIAL:** AISI 316L - 1.4404**GASKET:** EPDM cod. 826/GV (Ø 40 ÷ 65)  
EPDM cod. 826/G (Ø 80)**NORM:** EN 1124-3

B 100 102

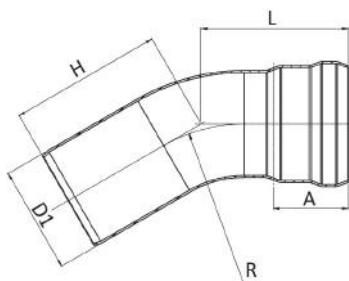

CODE	DN	D1 mm	L mm	A mm	H mm	R mm			€
804040045	40	42	68	30	71	63	0,146	1	20,53
804050045	50	53	85	38	88	80	0,229	1	24,26
804065045	65	73	112	55	117	110	0,521	1	45,19
804080045	80	88,9	128	60	133	133	0,864	1	52,19

**804/30****CURVA 30°**

- ELBOW 30°
- ROHRBOGEN 30°
- COUDE 30°
- CURVA 30°

**MATERIAL:** AISI 316L - 1.4404**GASKET:** EPDM cod. 826/GV (Ø 40 ÷ 65)  
EPDM cod. 826/G (Ø 80)**NORM:** EN 1124-3

B 100 102

CODE	DN	D1 mm	L mm	A mm	H mm	R mm			€
804040030	40	42	59	30	62	63	0,129	1	27,00
804050030	50	53	73	38	76	80	0,201	1	27,29
804065030	65	73	98	55	102	110	0,462	1	39,37
804080030	80	88,9	109	60	114	133	0,752	1	62,10

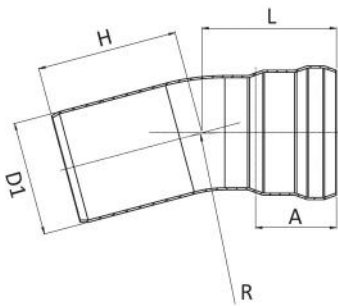
**B 100 102**

## 804/15

### CURVA 15°

- ELBOW 15°
- ROHRBOGEN 15°
- COUDE 15°
- CURVA 15°

**MATERIAL:** AISI 316L – 1.4404  
**GASKET:** EPDM cod. 826/GV (∅ 40 ÷ 65)  
 EPDM cod. 826/G (∅ 80)  
**NORM:** EN 1124-3

CODE	DN	D1 mm	L mm	A mm	H mm	R mm	kg		€
804040015	40	42	51	30	54	63	0,114	1	31,40
804050015	50	53	62	38	65	80	0,173	1	37,61
804065015	65	73	82	55	86	110	0,393	1	39,43
804080015	80	88,9	90	60	95	133	0,632	1	66,31

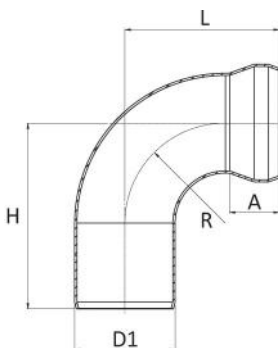

## 805/T

### CURVA TECNICA 87°

- TECHNICAL ELBOW 87°
- TECHNISCHE ROHRBOGEN 87°
- COUDE TECHNIQUE 87°
- CURVA TÉCNICA 87°

**MATERIAL:** AISI 316L – 1.4404  
**GASKET:** EPDM cod. 826/G (∅ 40 ÷ 50)  
 cod. 826/GV (∅ 65)  
**NORM:** EN 1124-3

**B 100 102**

CODE	DN	D1 mm	L mm	A mm	H mm	R mm	kg		€
805040000	40	42	64	20	79	42	0,159	1	27,48
805050000	50	53	81,5	26	98,5	53	0,252	1	32,00
805065000	65	73	127	55	142	73	0,720	1	61,32

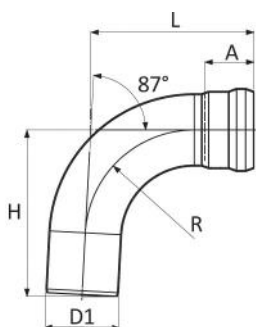

## 805/87

### CURVA RAGGIO STRETTO 87°

- ELBOW S.R. 87°
- ROHRBOGEN KURZE RADIUS 87°
- COUDE RAYON COURT 87°
- CURVA RADIO ESTRECHO 87°

**MATERIAL:** AISI 316L – 1.4404  
**GASKET:** EPDM cod. 826/GV (∅ 40 ÷ 65)  
 EPDM cod. 826/G (∅ 80 ÷ 150)  
**NORM:** EN 1124-3

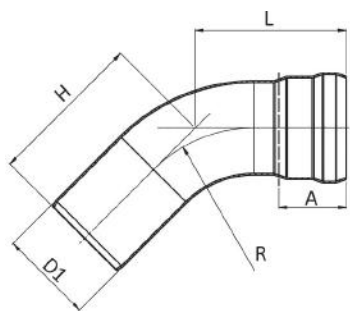

**B 100 102**

CODE	DN	D1 mm	L mm	A mm	H mm	R mm	kg		€
805040087	40	42	85	30	88	42	0,199	1	43,47
805050087	50	53	103	38	106	53	0,302	1	40,85
805065087	65	73	138	55	142	73	0,693	1	84,55
805080087	80	88,9	157	60	162	88,9	0,955	1	98,65
805100087	100	102	180	70	186	102	1,258	1	142,73
805125087	125	133	216	75	222	133	1,959	1	330,59
805150087	150	159	235	80	240	159	2,510	1	411,86

**805/45****B 100 102****CURVA RAGGIO STRETTO 45°**

- ELBOW S.R. 45°
- ROHRBOGEN KURZE RADIUS 45°
- COUDE RAYON COURT 45°
- CURVA RADIO ESTRECHO 45°

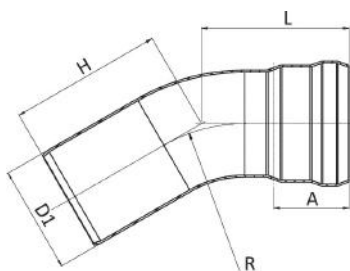

**MATERIAL:** AISI 316L - 1.4404**GASKET:** EPDM cod. 826/GV (Ø 40 ÷ 65)  
EPDM cod. 826/G (Ø 80 ÷ 150)**NORM:** EN 1124-3

CODE	DN	DI mm	L mm	A mm	H mm	R mm			€
805040045	40	42	60	30	63	42	0,156	1	28,43
805050045	50	53	74	38	77	53	0,241	1	29,04
805065045	65	73	98	55	102	73	0,549	1	51,73
805080045	80	88,9	109	60	114	88,9	0,744	1	64,58
805100045	100	102	124	70	126	102	0,958	1	90,36
805125045	125	133	147	75	154	133	1,502	1	261,53
805150045	150	159	159	80	147	159	1,825	1	343,19

**805/30****B 100 102****CURVA RAGGIO STRETTO 30°**

- ELBOW S.R. 30°
- ROHRBOGEN KURZE RADIUS 30°
- COUDE RAYON COURT 30°
- CURVA RADIO ESTRECHO 30°

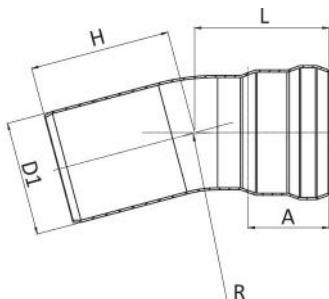

**MATERIAL:** AISI 316L - 1.4404**GASKET:** EPDM cod. 826/GV (Ø 40 ÷ 65)  
EPDM cod. 826/G (Ø 100 ÷ 150)**NORM:** EN 1124-3

CODE	DN	DI mm	L mm	A mm	H mm	R mm			€
805100030	100	102	110	70	115	102	0,877	1	116,90
805125030	125	133	125	75	131	133	1,298	1	267,58
805150030	150	159	136	80	124	159	1,580	1	373,69

**805/15****B 100 102****CURVA RAGGIO STRETTO 15°**

- ELBOW S.R. 15°
- ROHRBOGEN KURZE RADIUS 15°
- COUDE RAYON COURT 15°
- CURVA RADIO ESTRECHO 15°

**MATERIAL:** AISI 316L - 1.4404**GASKET:** EPDM cod. 826/G (Ø 100 ÷ 150)**NORM:** EN 1124-3

CODE	DN	DI mm	L mm	A mm	H mm	R mm			€
805100015	100	102	96	70	101	102	0,877	1	83,47
805125015	125	133	107	75	112	133	1,100	1	201,28
805150015	150	159	114	80	102	159	1,331	1	301,37

**B 100 102**

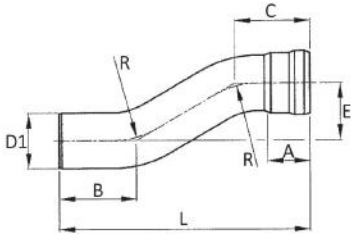

**806**

**DISASSAMENTO 75/130/200 MM**

- OFFSET 75/130/200 MM
- ETAGENBOGEN 75/130/200 MM
- DÉSAXEMENT 75/130/200 MM
- CURVA DESVIACIÓN 75/130/200 MM

**MATERIAL:** AISI 316L – 1.4404  
**GASKET:** EPDM cod. 826/GV (Ø 65)  
 EPDM cod. 826/G (Ø 80 ÷ 125)  
**NORM:** EN 1124-3

CODE	DN	D1 mm	E mm	L mm	A mm	B mm	C mm	R mm	kg	€
806065075	65	73	75	329	55	101	98	110	0,950	147,56
806080075	80	88,9	75	352	60	114	109	133	1,000	168,84
806100075	100	102	75	321	70	126	120	102	1,200	232,90
806125075	125	133	75	375,5	75	154	146,5	133	1,996	692,03
806065130	65	73	130	359	55	117	113	110	0,880	130,55
806080130	80	88,9	130	390	60	133	127	133	1,350	169,39
806100130	100	102	130	376	70	126	120	102	1,520	258,62
806125130	125	133	130	430,5	75	154	146,5	133	2,381	720,94
806065200	65	73	200	430	55	117	113	110	1,120	132,66
806080200	80	88,9	200	460	60	133	127	133	1,550	191,61
806100200	100	102	200	446	70	126	120	102	1,780	310,56
806125200	125	133	200	500,5	75	154	146,5	133	2,870	845,79

**B 100 102**

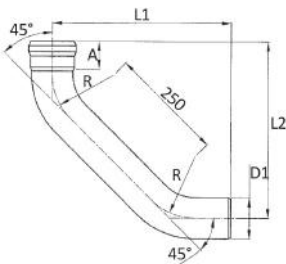

Articolo speciale a richiesta.  
 Special code on demand.

**807**

**CURVA PROLUNGATA**

- STREMLINE BEND
- LANG ROHRBOGEN
- COUDE PROLONGÉE
- CURVA EXTENDIDA

**MATERIAL:** AISI 316L – 1.4404  
**GASKET:** EPDM cod. 826/GV (Ø 50 ÷ 65)  
 EPDM cod. 826/G (Ø 80 ÷ 150)  
**NORM:** EN 1124-3

CODE	DN	D1 mm	L1 mm	L2 mm	A mm	R mm	kg	€
807050000	50	53	285	282	38	53	0,713	on demand
807065000	65	73	321,5	317,5	55	73	1,410	on demand
807080000	80	88,9	388	383	60	133	1,850	178,40
807100000	100	102	362,5	356,5	70	102	2,100	300,45
807125000	125	133	414	407	75	133	3,292	817,53
807150000	150	159	417	429	80	159	4,183	on demand

B 100 102

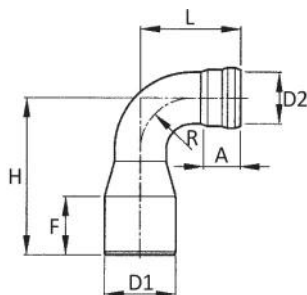

Articolo speciale a richiesta.  
Special code on demand.

**807/R****GOMITO RIDOTTO 87°**

- REDUCED ELBOW 87°
- REDUZIERTE ROHRBOGEN 87°
- COUDE RÉDUIT 87°
- CURVA REDUCIDA 87°

**MATERIAL:** AISI 316L - 1.4404**GASKET:** EPDM cod. 826/GV (Ø 50 ÷ 65)**NORM:** EN 1124-3

CODE	DN1	DN2	D1 mm	D2 mm	A mm	L mm	H mm	F mm	R mm	kg	€
807050040	50	40	53	42	30	85	124	62	42	0,290	102,36
807065050	65	50	73	53	38	103	161	60	53	0,390	113,42

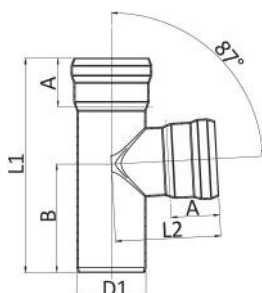
**808/87****BRAGA 87°**

- BRANCH 87°
- ABZWEIG 87°
- EMBRANCHEMENT 87°
- DERIVACIÓN M-H 87°

**MATERIAL:** AISI 316L - 1.4404**GASKET:** EPDM cod. 826/GV (Ø 40 ÷ 65)

EPDM cod. 826/G (Ø 80 ÷ 150)

**NORM:** EN 1124-3

B 100 102

CODE	DN	D1 mm	A mm	L1 mm	L2 mm	B mm	kg	€
808040087	40	42	30	137	67	69,5	0,193	66,93
808050087	50	53	38	165	81	83,5	0,291	70,19
808065087	65	73	55	209	109	106	0,639	82,60
808080087	80	88,9	60	235	123	119	0,863	89,55
808100087	100	102	70	291	138	147,5	1,196	124,85
808125087	125	133	75	360	159	182	2,219	195,53
808150087	150	159	80	403	178	204	2,932	261,13

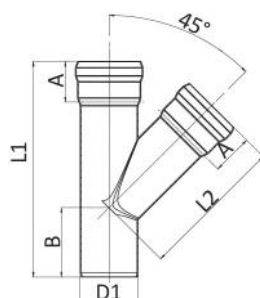
**808/45****BRAGA 45°**

- BRANCH 45°
- ABZWEIG 45°
- EMBRANCHEMENT 45°
- DERIVACIÓN M-H 45°

**MATERIAL:** AISI 316L - 1.4404**GASKET:** EPDM cod. 826/GV (Ø 40 ÷ 65)

EPDM cod. 826/G (Ø 80 ÷ 150)

**NORM:** EN 1124-3

B 100 102

CODE	DN	D1 mm	A mm	L1 mm	L2 mm	B mm	kg	€
808040045	40	42	30	155	100	55	0,233	78,65
808050045	50	53	38	198	132,5	64	0,382	81,70
808065045	65	73	55	255	170	85	0,864	102,14
808080045	80	88,9	60	295	210	95	1,200	123,26
808100045	100	102	70	335	225	110	1,517	139,43
808125045	125	133	75	415	285	130	2,936	236,14
808150045	150	159	80	460	320	140	3,856	302,93

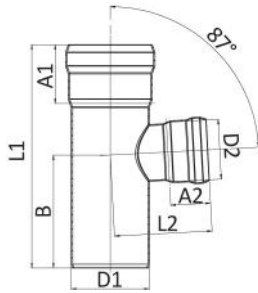

**B 100 102**

## 809

### BRAGA RIDOTTA 87°

- REDUCED BRANCH 87°
- REDUZIERTE ABZWEIG 87°
- EMBRANCHEMENT RÉDUIT 87°
- DERIVACIÓN M-H REDUCIDA 87°

**MATERIAL:** AISI 316L - 1.4404  
**GASKET:** EPDM cod. 826/GV (Ø 40 ÷ 65)  
 EPDM cod. 826/G (Ø 80 ÷ 150)  
**NORM:** EN 1124-3

CODE	DN1	DN2	D1 mm	D2 mm	A1 mm	A2 mm	L1 mm	L2 mm	B mm	kg	€
809050040	50	40	53	42	38	30	165	73	83,5	0,269	71,24
809065040	65	40	73	42	55	30	209	83	106	0,528	74,96
809065050	65	50	73	53	55	38	209	91	106	0,547	76,84
809080050	80	50	88,9	53	60	38	235	99	119	0,726	79,10
809100040	100	40	102	42	70	30	216	97	110	0,749	95,91
809100050	100	50	102	53	70	38	226	105	115	0,800	104,09
809100065	100	65	102	73	70	55	291	123	147,5	1,092	128,03
809100080	100	80	102	88,9	70	60	291	128	147,5	1,136	137,64
809125050	125	50	133	53	75	38	294	121	149	1,551	137,91
809125065	125	65	133	73	75	55	294	139	149	1,633	159,14
809125100	125	100	133	102	75	70	294	153	149	1,723	160,21
809150065	150	65	159	73	80	55	343	152	174	2,221	198,10
809150100	150	100	159	102	80	70	343	166	174	2,308	215,73
809150125	150	125	159	133	80	75	403	172	204	2,832	255,31

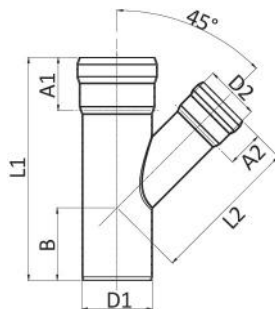

## 810

### BRAGA RIDOTTA 45°

- REDUCED BRANCH 45°
- REDUZIERTE ABZWEIG 45°
- EMBRANCHEMENT RÉDUIT 45°
- DERIVACIÓN M-H REDUCIDA 45°

**MATERIAL:** AISI 316L - 1.4404  
**GASKET:** EPDM cod. 826/GV (Ø 40 ÷ 65)  
 EPDM cod. 826/G (Ø 80 ÷ 150)  
**NORM:** EN 1124-3

**B 100 102**

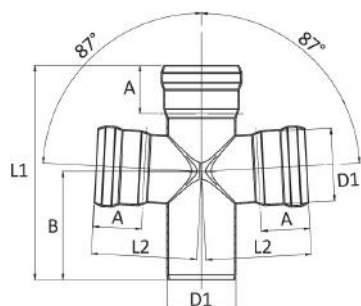

CODE	DN1	DN2	D1 mm	D2 mm	A1 mm	A2 mm	L1 mm	L2 mm	B mm	kg	€
810050040	50	40	53	42	38	30	198	147	65	0,373	73,34
810065040	65	40	73	42	55	30	205	145	60	0,563	81,22
810065050	65	50	73	53	55	38	230	155	75	0,651	84,45
810080050	80	50	88,9	53	60	38	245	173	72	0,820	100,63
810080065	80	65	88,9	73	60	55	255	180	85	0,961	100,63
810100040	100	40	102	42	70	30	250	185	65	0,916	108,86
810100050	100	50	102	53	70	38	270	195	75	1,019	123,33
810100065	100	65	102	73	70	55	300	210	95	1,257	131,65
810100080	100	80	102	88,9	70	60	320	220	100	1,408	139,29
810125050	125	50	133	53	75	38	300	225	75	1,671	155,48
810125065	125	65	133	73	75	55	330	240	90	2,236	181,84
810125100	125	100	133	102	75	70	365	260	105	2,294	208,14
810150065	150	65	159	73	80	55	330	240	90	2,314	264,19
810150100	150	100	159	102	80	70	370	281	89	2,695	276,17
810150125	150	125	159	133	80	75	420	300	120	3,358	317,02

B 100 102

**811/87****BRAGA DOPPIA 87°**

- DOUBLE BRANCH 87°
- DOPPELABZWEIG 87°
- EMBRANCHEMENT DOUBLE 87°
- DERIVACIÓN DOBLE M-H 87°

**MATERIAL:** AISI 316L - 1.4404**GASKET:** EPDM cod. 826/GV (Ø 50 ÷ 65)  
EPDM cod. 826/G (Ø 100 ÷ 150)**NORM:** EN 1124-3

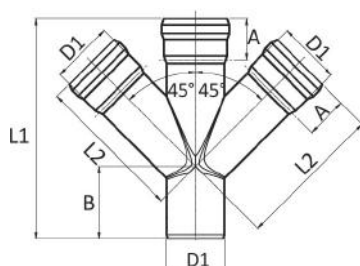

CODE	DN	D1 mm	A mm	L1 mm	L2 mm	B mm			€
811050087	50	53	38	165	81	83,5	0,359	1	116,43
811065087	65	73	55	209	109	105,5	0,792	1	133,26
811100087	100	102	70	291	138	147,5	1,451	1	218,22
811125087	125	133	75	360	159	182	2,616	1	307,54
811150087	150	159	80	403	178	204	3,422	1	396,22

B 100 102

**811/45****BRAGA DOPPIA 45°**

- DOUBLE BRANCH 45°
- DOPPELABZWEIG 45°
- EMBRANCHEMENT DOUBLE 45°
- DERIVACIÓN DOBLE M-H 45°

**MATERIAL:** AISI 316L - 1.4404**GASKET:** EPDM cod. 826/GV (Ø 50 ÷ 65)  
EPDM cod. 826/G (Ø 100 ÷ 150)**NORM:** EN 1124-3

CODE	DN	D1 mm	A mm	L1 mm	L2 mm	B mm			€
811050045	50	53	38	198	132,5	65	0,497	1	132,20
811065045	65	73	55	255	170	85	1,078	1	165,58
811100045	100	102	70	335	225	110	1,953	1	236,66
811125045	125	133	75	415	285	130	3,780	1	355,32
811150045	150	159	80	460	320	140	4,938	1	473,27

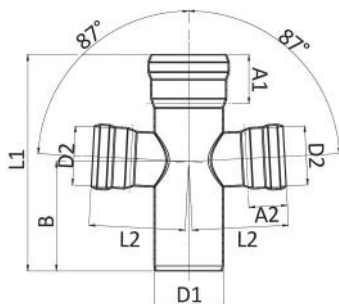
**B 100 102**

**812**
**BRAGA DOPPIA RIDOTTA 87°**

- REDUCED DOUBLE BRANCH 87°
- REDUZIERTE DOPPELABZWEIG 87°
- EMBRANCHEMENT DOUBLE RÉDUIT 87°
- DERIVACIÓN DOBLE M-H REDUCIDA 87°

**MATERIAL:** AISI 316L - 1.4404

**GASKET:** EPDM cod. 826/GV (Ø 40 ÷ 65)  
 EPDM cod. 826/G (Ø 80 ÷ 150)

**NORM:** EN 1124-3

CODE	DN1	DN2	D1 mm	D2 mm	A1 mm	A2 mm	L1 mm	L2 mm	B mm	kg	€
812050040	50	40	53	42	38	30	165	73	83,5	0,315	104,08
812065050	65	50	73	53	55	38	209	91	105,5	0,610	118,95
812080050	80	50	88,9	53	60	38	235	99	119	0,788	127,24
812100050	100	50	102	53	70	38	226	105	115	0,860	185,55
812100065	100	65	102	73	70	55	291	123	147,5	1,242	192,06
812100080	100	80	102	88,9	70	60	291	128	147,5	1,330	210,00
812125100	125	100	133	102	75	70	294	158	149	1,949	246,07
812150100	150	100	159	102	80	70	343	166	174	2,531	297,15
812150125	150	125	159	133	80	75	403	172	204	3,223	374,21

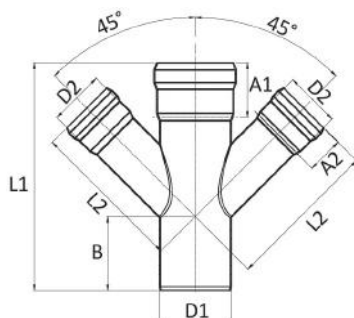
**813**
**BRAGA DOPPIA RIDOTTA 45°**

- REDUCED DOUBLE BRANCH 45°
- REDUZIERTE DOPPELABZWEIG 45°
- EMBRANCHEMENT DOUBLE RÉDUIT 45°
- DERIVACIÓN DOBLE M-H REDUCIDA 45°

**MATERIAL:** AISI 316L - 1.4404

**GASKET:** EPDM cod. 826/GV (Ø 40 ÷ 65)  
 EPDM cod. 826/G (Ø 80 ÷ 150)

**NORM:** EN 1124-3

**B 100 102**

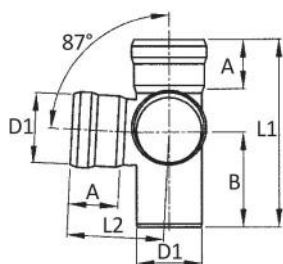

CODE	DN1	DN2	D1 mm	D2 mm	A1 mm	A2 mm	L1 mm	L2 mm	B mm	kg	€
813050040	50	40	53	42	38	30	168	118	50	0,383	126,26
813065050	65	50	73	53	55	38	230	155	75	0,771	151,13
813080050	80	50	88,9	53	60	38	245	173	72	0,945	167,98
813100065	100	65	102	73	70	55	300	210	90	1,540	212,00
813100080	100	80	102	88,9	70	60	320	220	100	1,780	229,31
813125100	125	100	133	102	75	70	370	260	105	2,741	286,35
813150100	150	100	159	102	80	70	370	281	89	3,146	330,19
813150125	150	125	159	133	80	75	420	300	120	4,175	429,22

B 100 102

**814/87****BRAGA SCAGNO 87°**

- CORNER BRANCH 87°
- WINKEL ABZWEIG 87°
- TÉ DOUBLE ÉQUERRE 87°
- T DOBLE ESCUADRA 87°

**MATERIAL:** AISI 316L - 1.4404**GASKET:** EPDM cod. 826/GV (Ø 50 ÷ 65)  
EPDM cod. 826/G (Ø 80 ÷ 150)**NORM:** EN 1124-3

CODE	DN	D1 mm	L1 mm	L2 mm	A mm	B mm			€
814050087	50	53	164,5	81	38	83,5	0,350	1	162,93
814065087	65	73	209	109	55	106	0,930	1	226,01
814080087	80	88,9	235	122	60	119	1,230	1	265,57
814100087	100	102	290,5	138	70	147	1,810	1	273,43
814125087	125	133	359,5	159	75	182	2,602	1	382,48
814150087	150	159	402,5	178	80	204	3,394	1	484,25

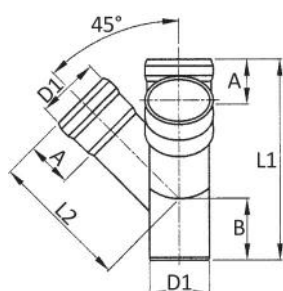



Articolo speciale a richiesta.  
Special code on demand.

**814/45****BRAGA SCAGNO 45°**

- CORNER BRANCH 45°
- WINKEL ABZWEIG 45°
- TÉ DOUBLE ÉQUERRE 45°
- T DOBLE ESCUADRA 45°

**MATERIAL:** AISI 316L - 1.4404**GASKET:** EPDM cod. 826/GV (Ø 50 ÷ 65)  
EPDM cod. 826/G (Ø 80 ÷ 150)**NORM:** EN 1124-3

B 100 102

CODE	DN	D1 mm	A mm	L1 mm	L2 mm	B mm			€
814050045	50	53	38	188	123	65	0,450	1	132,85
814065045	65	73	55	255	170	85	1,000	1	168,78
814080045	80	88,9	60	295	210	95	1,450	1	206,12
814100045	100	102	70	335	225	110	2,400	1	240,82
814125045	125	133	75	415	285	130	3,757	1	378,89
814150045	150	159	80	460	320	140	4,902	1	506,27

**B 100 102**

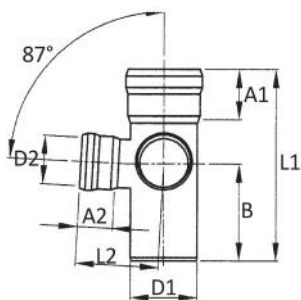

## 815/87

### BRAGA SCAGNO RIDOTTA 87°

- REDUCED CORNER BRANCH 87°
- REDUZIERT WINKEL ABZWEIG 87°
- TÉ DOUBLE ÉQUERRE RÉDUIT 87°
- T DOBLE ESCUADRA REDUCIDA 87°

**MATERIAL:** AISI 316L – 1.4404  
**GASKET:** EPDM cod. 826/GV (Ø 40 ÷ 65)  
 EPDM cod. 826/G (Ø 80 ÷ 150)  
**NORM:** EN 1124-3

CODE	DN1	DN2	D1 mm	D2 mm	A1 mm	A2 mm	L1 mm	L2 mm	B mm	kg	€
815050040	50	40	53	42	38	30	164,5	72,5	83,5	0,410	104,15
815065050	65	50	73	53	55	38	209	90,5	106	0,720	124,30
815080050	80	50	88,9	53	60	38	235	98,5	119	1,160	135,87
815100065	100	65	102	73	70	55	290,5	123	147	1,440	167,08
815100080	100	80	102	88,9	70	60	290,5	128	147	1,590	190,80
815125100	125	100	133	102	75	70	293,5	153	149	1,949	255,75
815150100	150	100	159	102	80	70	342,5	166	174	2,530	330,19
815150125	150	125	159	133	80	75	402,5	195	204	3,445	422,60

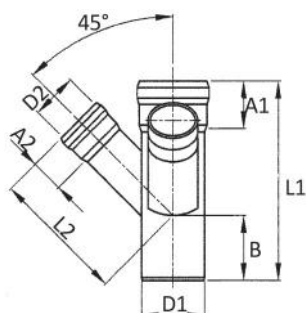

Articolo speciale a richiesta.  
 Special code on demand.

## 816/45

### BRAGA SCAGNO RIDOTTA 45°

- REDUCED CORNER BRANCH 45°
- REDUZIERT WINKEL ABZWEIG 45°
- TÉ DOUBLE ÉQUERRE RÉDUIT 45°
- T DOBLE ESCUADRA REDUCIDA 45°

**MATERIAL:** AISI 316L – 1.4404  
**GASKET:** EPDM cod. 826/GV (Ø 40 ÷ 65)  
 EPDM cod. 826/G (Ø 100 ÷ 150)  
**NORM:** EN 1124-3

**B 100 102**

CODE	DN1	DN2	D1 mm	D2 mm	A1 mm	A2 mm	L1 mm	L2 mm	B mm	kg	€
816050040	50	40	53	42	38	30	168	118	50	0,350	126,77
816065050	65	50	73	53	55	38	230	155	75	0,850	149,19
816100065	100	65	102	73	70	55	300	210	90	1,900	203,07
816125100	125	100	133	102	75	70	365	260	105	2,742	278,67
816150100	150	100	159	102	80	70	370	275	95	3,109	347,80
816150125	150	125	159	133	80	75	425	300	120	4,169	473,27



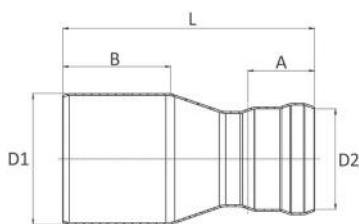

B 100 102

**817****RIDUZIONE CONCENTRICA**

- CONCENTRIC REDUCER
- REDUZIERSTÜCK KONZENTRISCH
- RÉDUCTION CONCENTRIQUE
- REDUCCIÓN CONCÉNTRICA

**MATERIAL:** AISI 316L - 1.4404**GASKET:** EPDM cod. 826/GV (Ø 40 ÷ 65)  
EPDM cod. 826/G (Ø 80 ÷ 125)**NORM:** EN 1124-3

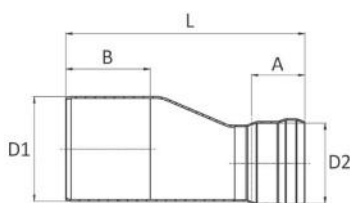

CODE	DN1	DN2	D1 mm	D2 mm	A mm	L mm	B mm			€
817050040	40	50	53	42	30	120	62	0,150	1	62,73
817065040	40	65	73	42	30	121	62	0,235	1	60,65
817065050	50	65	73	53	38	140	60	0,230	1	68,53
817100050	50	100	102	53	38	165	89	0,506	1	119,45
817080065	65	80	88,9	73	55	195	80	0,475	1	74,49
817100065	65	100	102	73	55	184	85	0,545	1	79,38
817125065	65	125	133	73	55	197,5	95	0,818	1	157,21
817100080	80	100	102	88,9	60	190	85	0,583	1	81,24
817125100	100	125	133	102	70	249	85	0,833	1	94,48
817150100	100	150	159	102	70	247	101	1,222	1	236,72
817150125	125	150	159	133	75	230	95	1,308	1	208,30

B 100 102

**818****RIDUZIONE ECCENTRICA**

- ECCENTRIC REDUCER
- REDUZIERSTÜCK EXZENTRISCH
- RÉDUCTION EXCENTRIQUE
- REDUCCIÓN EXCÉNTRICA

**MATERIAL:** AISI 316L - 1.4404**GASKET:** EPDM cod. 826/GV (Ø 40 ÷ 65)  
EPDM cod. 826/G (Ø 80 ÷ 125)**NORM:** EN 1124-3

CODE	DN1	DN2	D1 mm	D2 mm	A mm	L mm	B mm			€
818050040	40	50	53	42	30	125	45	0,170	1	121,45
818065050	50	65	73	53	38	167	70	0,322	1	131,61
818100050	50	100	102	53	38	197	87	0,474	1	182,85
818080065	65	80	88,9	73	55	187	77	0,465	1	146,26
818100065	65	100	102	73	55	207	87	0,590	1	220,21
818100080	80	100	102	88,9	60	207	87	0,635	1	174,90
818125100	100	125	133	102	70	239	94	1,037	1	210,81
818150125	125	150	159	133	75	243	101	1,382	1	260,73

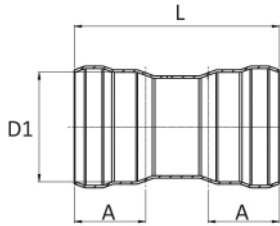
**B 100 102**

## 819/000

### MANICOTTO

- COUPLING
- MUFFE
- MANCHON
- MANGUITO

**MATERIAL:** AISI 316L - 1.4404

**GASKET:** EPDM cod. 826/GV (Ø 40 ÷ 65)  
 EPDM cod. 826/G (Ø 80 ÷ 150)

**NORM:** EN 1124-3

CODE	DN	D1 mm	A mm	L mm	kg		€
819040000	40	42	30	84	0,098	1	29,61
819050000	50	53	38	94	0,138	1	31,86
819065000	65	73	55	135	0,335	1	41,40
819080000	80	88,9	60	145	0,438	1	44,22
819100000	100	102	70	180	0,622	1	49,63
819125000	125	133	75	190	1,000	1	67,09
819150000	150	159	80	200	1,290	1	94,02

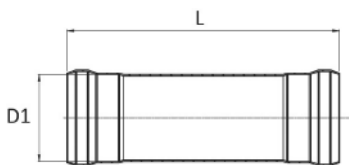
**B 100 102**

## 819/001

### MANICOTTO PASSANTE

- SLIP COUPLING
- SCHIEBEMUFFE
- MANCHON LONG
- MANGUITO SIN TOPE

**MATERIAL:** AISI 316L - 1.4404

**GASKET:** EPDM cod. 826/G (Ø 40 ÷ 150)

**NORM:** EN 1124-3

CODE	DN	D1 mm	L mm	kg		€
819040001	40	42	142	0,163	1	46,33
819050001	50	53	176	0,251	1	51,68
819065001	65	73	255	0,654	1	62,63
819080001	80	88,9	294	0,865	1	71,17
819100001	100	102	334	1,130	1	82,78
819125001	125	133	405	2,100	1	159,94
819150001	150	159	473	2,960	1	320,58

B 100 102

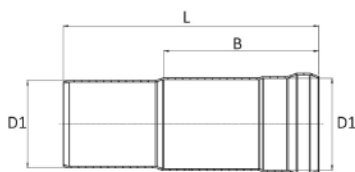
**819/002****MANICOTTO PROLUNGATO**

- SLIDE COUPLING
- DEHNUNGSMUFFE
- MANCHON PROLONGÉE
- MANGUITO EXTENDIDO

**MATERIAL:** AISI 316L - 1.4404**GASKET:** EPDM cod. 826/G (Ø 40 ÷ 150)**NORM:** EN 1124-3

CODE	DN	D1 mm	B mm	L mm	kg		€
819040002	40	42	69	120	0,132	1	40,65
819050002	50	53	94	155	0,214	1	48,54
819065002	65	73	139	205	0,486	1	60,61
819080002	80	88,9	134	210	0,605	1	63,80
819100002	100	102	148	240	0,794	1	72,28
819125002	125	133	158	260	1,300	1	120,13
819150002	150	159	168	285	1,758	1	216,66

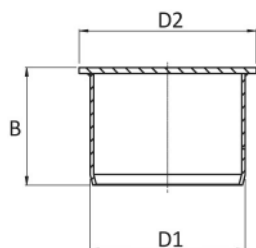
**819/003****TAPPO**

- STOP END
- VERSCHLUSSSTOPFEN
- BOUCHON
- TAPÓN

**MATERIAL:** AISI 316L - 1.4404

B 100 102

CODE	DN	D1 mm	D2 mm	B mm	kg		€
819040003	40	42	50	32	0,068	1	35,45
819050003	50	53	60,5	40,5	0,106	1	40,85
819065003	65	73	80,5	57,5	0,230	1	47,85
819080003	80	88,9	98	62	0,317	1	60,55
819100003	100	102	112	72	0,420	1	74,78
819125003	125	133	145	77	0,634	1	109,63
819150003	150	159	174	82	0,854	1	121,18

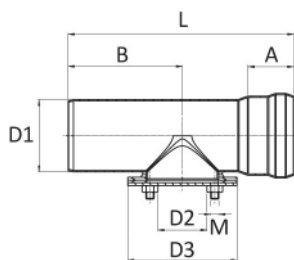
**B 100 102**

## 819/004

### ISPEZIONE

- CLEANOUT PORT
- REVISIONSROHR
- OUVERTURE DE NETTOYAGE
- INSPECCIÓN

**MATERIAL:** AISI 316L - 1.4404

**GASKET:** EPDM cod. 826/GV (Ø 40 ÷ 65)  
 EPDM cod. 826/G (Ø 80 ÷ 150)

**NORM:** EN 1124-3

CODE	DN	D1 mm	D2 mm	D3 mm	A mm	L mm	M	Screw Nr.	B mm	kg	€
819040004	40	42	42	70	30	142,5	M6	4	70	0,286	131,32
819050004	50	53	53	80	38	165	M6	4	84	0,380	135,84
819065004	65	73	73	105	55	225	M8	4	115	0,795	168,32
819080004	80	88,9	88,9	125	60	255	M8	4	130	1,070	185,87
819100004	100	102	88,9	125	70	291	M8	4	148	1,292	196,67
819125004	125	133	133	165	75	360	M8	8	182	2,647	331,02
819150004	150	159	133	165	80	403	M8	8	204	3,257	413,63

**B 100 102**

## 827

### ADATTATORE FEMMINA-MASCHIO

- ADAPTER FEMALE-MALE
- ADAPTER I-A
- ADAPTATEUR FEMELLE-MÂLE
- ADAPTADOR HEMBRA-MACHO

**MATERIAL:** AISI 316L - 1.4404

**NORM:** EN 1124-3

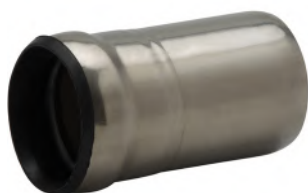
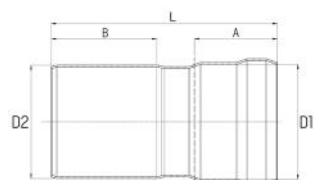
**GASKET:** EPDM cod. 826/GV (Ø 40 ÷ 65)

CODE	DN	D1 mm	D2 mm	A mm	B mm	L mm	kg	€
827042040	40	42	40	30	60	110	0,126	27,10
827053050	50	53	50	38	60	120	0,177	28,46
827073075	65	73	75	55	70	150	0,392	34,43

**B 100 102**

## 827/000

### COLLARE ANTIFILAMENTO

- SAFETY COLLAR
- SICHERHEITSSCHELLE
- COLLIER DE SÉCURITÉ
- ABRAZADERA DE SEGURIDAD

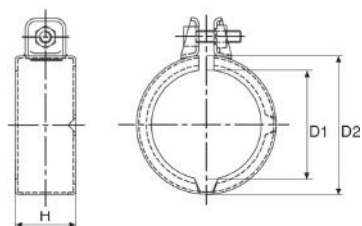
**MATERIAL:** AISI 316L - 1.4404

CODE	DN	D1 mm	D2 mm	H mm	kg	€
827040000	40	42	56	27	0,120	53,36
827050000	50	53	68	31	0,150	54,57
827065000	65	73	92,5	40	0,300	64,65
827080000	80	88,9	110,5	44	0,380	71,33
827100000	100	102	124,5	53	0,500	78,71
827125000	125	133	162	58	0,687	94,53
827150000	150	159	191	63	0,860	111,74

B 100 102

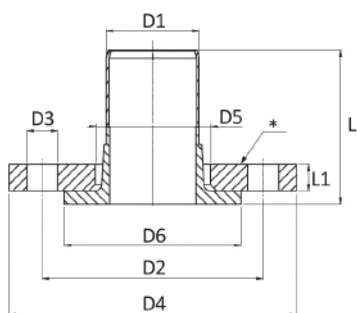
**820/PN6****BOCCELLO CON FLANGIA GIREVOLE**

- SLEEVE / ROTARY FLANGE
- LOSE-FLANSCH / AUSSEN
- BRIDE TOURNANTE / SORTIE A BRIDE
- BRIDA LOCA / TRONCO EMBRIDADO

**MATERIAL:** AISI 316L - 1.4404**NOTE:** [\*] S235JR (Fe 360) zincata - galvanizad - verzinkt - galvanisés - galvanizado**PN 6**

CODE	DN	D1 mm	L mm	L1 mm	D2 mm	D3 mm	D4 mm	D5 mm	D6 mm	Holes Nr.	kg		€
820040006	40	42	70	12	100	14	130	52	80	4	1,304	1	133,66
820050006	50	53	80	12	110	14	140	64	90	4	1,544	1	162,57
820065006	65	73	100	12	130	14	160	83	110	4	1,975	1	199,57
820080006	80	88,9	110	14	150	18	190	96	128	4	3,166	1	266,85
820100006	100	102	130	14	170	18	210	113	148	4	3,805	1	303,72
820125006	125	133	150	14	200	18	240	140	178	8	4,770	1	513,18
820150006	150	159	170	14	225	18	265	166	202	8	5,516	1	624,66

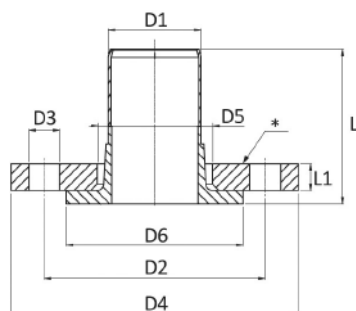
**820/PN16****BOCCELLO CON FLANGIA GIREVOLE**

- SLEEVE / ROTARY FLANGE
- LOSE-FLANSCH / AUSSEN
- BRIDE TOURNANTE / SORTIE A BRIDE
- BRIDA LOCA / TRONCO EMBRIDADO

**MATERIAL:** AISI 316L - 1.4404**NOTE:** [\*] S235JR (Fe 360) zincata - galvanizad - verzinkt - galvanisés - galvanizado**PN 16**

CODE	DN	D1 mm	L mm	L1 mm	D2 mm	D3 mm	D4 mm	D5 mm	D6 mm	Holes Nr.	kg		€
820040010	40	42	70	16	110	18	150	52	88	4	2,181	1	138,26
820050010	50	53	80	18	125	18	165	64	102	4	2,978	1	191,59
820065010	65	73	100	18	145	18	185	83	122	4	3,659	1	219,34
820080010	80	88,9	110	20	160	18	200	96	138	8	4,580	1	272,09
820100010	100	102	130	20	180	18	220	113	158	8	5,455	1	342,13
820125010	125	133	150	22	210	18	250	140	188	8	7,377	1	560,71
820150010	150	159	170	22	240	22	285	166	212	8	9,029	1	678,74

B 100 102

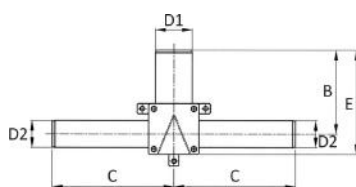

Articolo speciale a richiesta.  
Special code on demand.

**820/I****BRAGA RIDOTTA CON ISPEZIONE**

- REDUCED BRANCH WITH CLEANOUT
- REDUZIERTER BRANCH / INSPEKTION
- EMBRANCHEMENT RÉDUIT / INSPECTION
- DERIVACIÓN REDUCIDA / INSPECCIÓN

**MATERIAL:** AISI 316L - 1.4404

CODE	DN1	DN2	D1 mm	D2 mm	B mm	C mm	E mm	kg		€
820205000	65	50	73	53	165	240	205	2,120	1	207,28
820260000	65	50	73	53	220	240	260	2,280	1	275,35

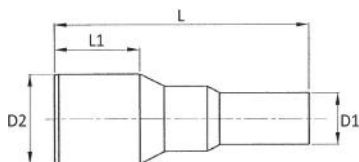

**B 100 102**

 Articolo speciale a richiesta.  
 Special code on demand.

## 820/R

### RIDUZIONE L=1000 MM

- REDUCER WITHOUT SOCKET L=1000 MM
- REDUZIERSTÜCK A-A L=1000 MM
- RÉDUCTION L=1000 MM
- REDUCCIÓN L=1000 MM

**MATERIAL:** AISI 316L - 1.4404

CODE	D1 mm	D2 mm	L mm	L1 mm	kg	€
820065040	42	73	1000	70	1,336	134,57

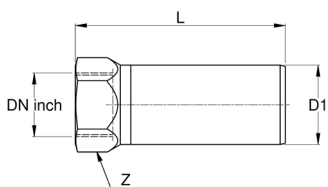
**B 100 102**

## 820/F

### RACCORDO FILETTATO FEMMINA

- FEMALE THREADED CONNECTOR
- ÜBERGANGSSTÜCK MIT IG
- RACCORD FILETÉ FEMELLE
- RACOR ROSCA HEMBRA

**MATERIAL:** AISI 316L - 1.4404

CODE	DN	D1 mm	DN inch	L mm	Z mm	kg	€
820040100	40	42	1"	140	46	0,290	134,76
820040114	40	42	1"1/4	140	46	0,270	67,79
820040112	40	42	1"1/2	140	55	0,390	71,45
820050114	50	53	1"1/4	140	55	0,440	156,22
820050112	50	53	1"1/2	140	55	0,370	162,00
820050200	50	53	2"	140	70	0,660	170,04

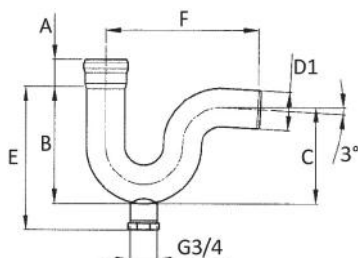
**B 100 102**

## 820/S

### SIFONE

- TRAP
- SYPHON
- SIPHON
- SIFÓN

**MATERIAL:** AISI 316L - 1.4404  
**GASKET:** EPDM cod. 826/GV (Ø 40 ÷ 50)  
**NORM:** EN 1124-3

CODE	DN	D1 mm	A mm	B mm	C mm	E mm	F mm	kg	€
820040000	40	42	30	128	105	162	172	0,700	239,72
820050000	50	53	38	161	132,5	198	212	0,990	335,92

B 100 102

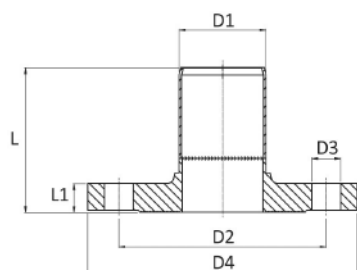
**821/PN6****FLANGIA CON RACCORDO MASCHIO PN6**

- FLANGE WITH SPIGOT PN6
- FLANSCHADAPTER / AUSSEN PN6
- BRIDE DE RACCORD / MALE PN6
- BRIDA ADAPTADOR / MACHO PN6

**PN 6****MATERIAL:** AISI 316L - 1.4404

CODE	DN	D1 mm	L mm	L1 mm	D2 mm	D3 mm	D4 mm	Holes Nr.	kg	€
821040006	40	42	70	14	100	14	130	4	1,301	112,07
821050006	50	53	78,5	14	110	14	140	4	1,475	136,30
821065006	65	73	97,5	14	130	14	160	4	1,897	167,33
821080006	80	88,9	105	16	150	18	190	4	2,979	235,74
821100006	100	102	115	16	170	18	210	4	3,497	268,32
821125006	125	133	116	10	200	18	240	8	2,792	453,34
821150006	150	159	122	10	225	18	265	8	3,245	538,81

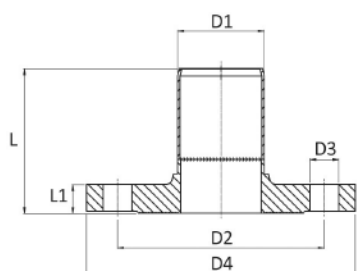
**821/PN16****FLANGIA CON RACCORDO MASCHIO**

- FLANGE WITH SPIGOT
- FLANSCHADAPTER / AUSSEN
- BRIDE DE RACCORD / MALE
- BRIDA ADAPTADOR / MACHO

**PN 16****MATERIAL:** AISI 316L - 1.4404

B 100 102

CODE	DN	D1 mm	L mm	L1 mm	D2 mm	D3 mm	D4 mm	Holes Nr.	kg	€
821040010	40	42	72	16	110	18	150	4	1,968	139,59
821050010	50	53	82,5	18	125	18	165	4	2,650	177,33
821065010	65	73	101,5	18	145	18	185	4	3,270	202,99
821080010	80	88,9	109	20	160	18	200	8	3,995	240,36
821100010	100	102	119	20	180	18	220	8	4,670	302,26
821125010	125	133	118	12	210	18	250	8	3,625	460,89
821150010	150	159	125	12	240	22	285	8	4,482	554,03

**B 100 102**

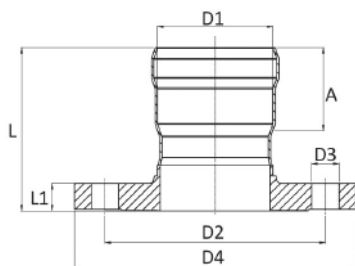

### 822/PN6

#### FLANGIA CON RACCORDO FEMMINA PN6

- FLANGE WITH SOCKET PN6
- FLANSCHADAPTER / INNEN PN6
- BRIDE DE RACCORD / FEMELLE PN6
- BRIDA ADAPTADOR / HEMBRA PN6

**MATERIAL:** AISI 316L - 1.4404  
**GASKET:** EPDM cod. 826/GV (Ø 40 ÷ 65)  
 EPDM cod. 826/G (Ø 80 ÷ 150)  
**NORM:** EN 1124-3

**PN 6**

CODE	DN	D1 mm	A mm	L mm	L1 mm	D2 mm	D3 mm	D4 mm	Holes Nr.	kg	€
822040006	40	42	30	67	14	100	14	130	4	1,304	124,53
822050006	50	53	38	75	14	110	14	140	4	1,477	157,31
822065006	65	73	55	104	14	130	14	160	4	1,931	202,09
822080006	80	88,9	60	100	16	150	18	190	4	2,986	277,47
822100006	100	102	70	125	16	170	18	210	4	3,563	355,44
822125006	125	133	75	112	10	200	18	240	8	2,815	395,39
822150006	150	159	80	117,5	10	225	18	265	8	3,270	460,60

**B 100 102**

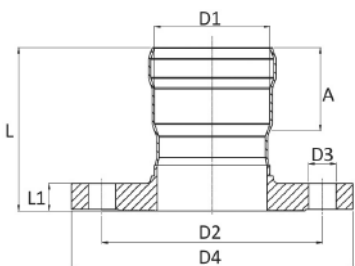

### 822/PN16

#### FLANGIA CON RACCORDO FEMMINA

- FLANGE WITH SOCKET
- FLANSCHADAPTER / INNEN
- BRIDE DE RACCORD / FEMELLE
- BRIDA ADAPTADOR / HEMBRA

**MATERIAL:** AISI 316L - 1.4404  
**GASKET:** EPDM cod. 826/GV (Ø 40 ÷ 65)  
 EPDM cod. 826/G (Ø 80 ÷ 150)  
**NORM:** EN 1124-3

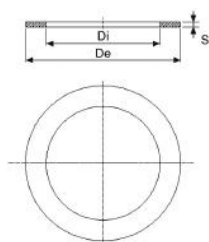

**PN 16**

CODE	DN	D1 mm	A mm	L mm	L1 mm	D2 mm	D3 mm	D4 mm	Holes Nr.	kg	€
822040010	40	42	30	69	16	110	18	150	4	1,972	161,29
822050010	50	53	38	79	18	125	18	165	4	2,653	180,21
822065010	65	73	55	108	18	145	18	185	4	3,301	213,87
822080010	80	88,9	60	104	20	160	18	200	8	4,000	246,26
822100010	100	102	70	129	20	180	18	220	8	4,736	381,77
822125010	125	133	75	114	12	210	18	250	8	3,648	433,26
822150010	150	159	80	119,5	12	240	22	285	8	4,504	495,35

**434/PN 6****R 30 30****GUARNIZIONE ECOLOGICA PER FLANGE**

- GASKET FOR FLANGE
- FLANSCHDICHTUNG
- JOINT POUR BRIDE
- JUNTA ECOLÓGICA PARA BRIDA

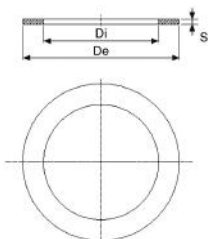

**PN 6**
**MATERIAL:** Sesalit Eco  
**NORM:** EN 1092-1

CODE	DN	De mm	Di mm	S mm			€
434040006	40 - [1"1/2]	85	45	2	14	10	2,71
434050006	50 - [2"]	95	57	2	15	10	4,14
434065006	65 - [2"1/2]	115	76	2	19	10	5,69
434080006	80 - [3"]	132	89	2	26	10	6,74
434100006	100 - [4"]	152	108	2	29	10	7,98
434125006	125 - [5"]	182	133	2	41	10	11,09
434150006	150 - [6"]	207	160	2	38	10	12,63

**434/PN 10-16****R 30 30****GUARNIZIONE ECOLOGICA PER FLANGE**

- GASKET FOR FLANGE
- FLANSCHDICHTUNG
- JOINT POUR BRIDE
- JUNTA ECOLÓGICA PARA BRIDA

**PN 10/16**
**MATERIAL:** Sesalit Eco  
**NORM:** EN 1092-1

CODE	DN	De mm	Di mm	S mm			€
434040000	40 - [1"1/2]	92	45	2	17	10	2,71
434050000	50 - [2"]	108	57	2	22	10	4,09
434065000	65 - [2"1/2]	127	76	2	27	10	5,65
434080000	80 - [3"]	142	89	2	30	10	6,68
434100000	100 - [4"]	162	108	2	38	10	7,67
434125000	125 - [5"]	192	140	2	44	10	10,78
434150000	150 - [6"]	218	169	2	55	10	12,30

**Sesalit ECO:** fibre organiche e sintetiche legate con gomma NBR/SBR esente amianto

**IMPIEGHI:** Acqua calda e fredda, olii vegetali ed animali, aria, alcuni carburanti (no GAS)
**LIMITI DI TEMPERATURA ORIENTATIVI**

Temperatura massima per brevi esposizioni: 180°-200° C

Temperatura massima di esercizio continuo per fluidi non aggressivi: 140° C

Temperatura massima di esercizio continuo con vapore: 110° C

**OMOLOGAZIONI:** acqua potabile WRAS n° 1605525

**Sesalit ECO:** organic and synthetic fibers bonded with NBR/SBR asbestos-free

**USES:** hot and cold water, vegetable and animal oils, air, some fuels (no GAS)
**GUIDELINE TEMPERATURE LIMITS**

Maximum temperature for short exposure: 180°-200° C

Maximum operating temperature for continuous non-aggressive fluids: 140° C

Maximum temperature for continuous operation with steam: 110° C

**APPROVAL:** potable water WRAS n° 1605525

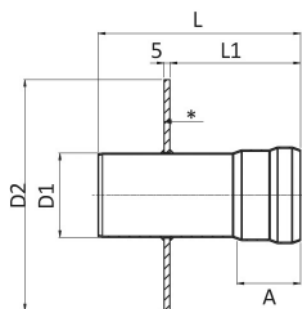
**B 100 102**

## 823/F1

### PASSAGGIO STAGNO F1

- DECK / BULKHEAD PENETRATION F1
- WANDDURCHFÜHRUNG F1
- PASSAGE ÉTANCHE F1
- PASAJE ESTAÑO F1

**MATERIAL:** AISI 316L – 1.4404  
**NOTE:** [\*] S235JR (Fe 360) verniciato - painted - bemalt - peint - pintado  
**GASKET:** EPDM cod. 826/GV (Ø 40 ÷ 65)  
 EPDM cod. 826/G (Ø 80 ÷ 150)  
**NORM:** EN 1124-3

CODE	DN	D1 mm	L mm	L1 mm	D2 mm	A mm	kg		€
823040000	40	42	161	93	200	30	1,345	1	105,11
823050000	50	53	202	118	200	38	1,410	1	108,38
823065000	65	73	279	165	200	55	1,470	1	136,64
823080000	80	88,9	332	194	200	60	1,510	1	156,22
823100000	100	102	381	223	200	70	2,130	1	174,13
823125000	125	133	479	275	250	75	3,775	1	247,53
823150000	150	159	562	319	250	80	4,511	1	290,38

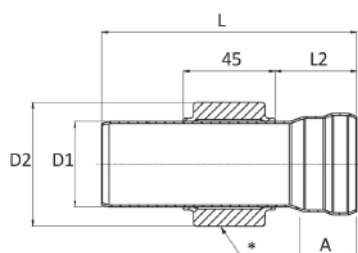
**B 100 102**

## 823/M1

### PASSAGGIO STAGNO M1

- DECK / BULKHEAD PENETRATION M1
- WANDDURCHFÜHRUNG M1
- PASSAGE ÉTANCHE M1
- PASAJE ESTAÑO M1

**MATERIAL:** AISI 316L – 1.4404  
**NOTE:** [\*] S235JR (Fe 360) verniciato - painted - bemalt - peint - pintado  
**GASKET:** EPDM cod. 826/GV (Ø 40 ÷ 65)  
 EPDM cod. 826/G (Ø 80 ÷ 150)  
**NORM:** EN 1124-3

CODE	DN	D1 mm	L mm	L2 mm	D2 mm	A mm	kg		€
823040001	40	42	125	40	61	30	0,533	1	75,71
823050001	50	53	145	50	70	38	0,612	1	88,29
823065001	65	73	175	65	88,9	55	0,926	1	120,59
823080001	80	88,9	185	70	110	60	1,394	1	141,23
823100001	100	102	205	80	121	70	1,501	1	152,22
823125001	125	133	215	85	150	75	1,979	1	189,83
823150001	150	159	225	90	178	80	2,613	1	282,02

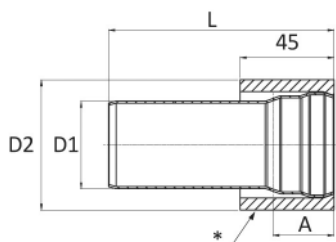

B 100 102

**823/M2****PASSAGGIO STAGNO M2**

- DECK / BULKHEAD PENETRATION M2
- WANDDURCHFÜHRUNG M2
- PASSAGE ÉTANCHE M2
- PASAJE ESTAÑO M2

**MATERIAL:** AISI 316L - 1.4404**NOTE:** (\*) S235JR (Fe 360) verniciato - painted - bemalt - peint - pintado**GASKET:** EPDM cod. 826/GV (Ø 40 ÷ 65)  
EPDM cod. 826/G (Ø 80 ÷ 150)**NORM:** EN 1124-3

CODE	DN	D1 mm	L mm	D2 mm	A mm	kg		€
823040002	40	42	108	62,5	30	0,485	1	60,90
823050002	50	53	125	75	38	0,645	1	63,10
823065002	65	73	155	101	55	1,180	1	88,40
823080002	80	88,9	178	113,5	60	1,200	1	109,21
823100002	100	102	198	133	70	1,760	1	136,81
823125002	125	133	245	168	75	2,773	1	172,49
823150002	150	159	284	193	80	3,116	1	240,23

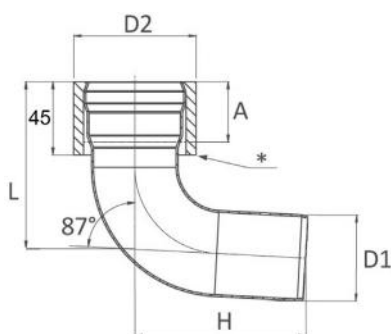
**823/M3****PASSAGGIO STAGNO M3**

- DECK / BULKHEAD PENETRATION M3
- WANDDURCHFÜHRUNG M3
- PASSAGE ÉTANCHE M3
- PASAJE ESTAÑO M3

**MATERIAL:** AISI 316L - 1.4404**NOTE:** (\*) S235JR (Fe 360) verniciato - painted - bemalt - peint - pintado**GASKET:** EPDM cod. 826/GV (Ø 40 ÷ 65)  
EPDM cod. 826/G (Ø 80 ÷ 100)**NORM:** EN 1124-3

CODE	DN	D1 mm	L mm	D2 mm	H mm	A mm	kg		€
823040003	40	42	85	62,5	88	30	0,564	1	63,89
823050003	50	53	103	75	106	38	0,771	1	87,48
823065003	65	73	138	101	142	55	1,510	1	140,28
823080003	80	88,9	157	113,5	162	60	1,485	1	175,73
823100003	100	102	180	133	186	70	2,365	1	251,06

**B 100 102**

## 823/M4

### PASSAGGIO STAGNO M4

- DECK / BULKHEAD PENETRATION M4
- WANDDURCHFÜHRUNG M4
- PASSAGE ÉTANCHE M4
- PASAJE ESTAÑO M4

**MATERIAL:** AISI 316L – 1.4404  
**NOTE:** [\*] S235JR (Fe 360) verniciato - painted - bemalt - peint - pintado  
**GASKET:** EPDM cod. 826/GV (Ø 40 ÷ 65)  
 EPDM cod. 826/G (Ø 80 ÷ 150)  
**NORM:** EN 1124-3

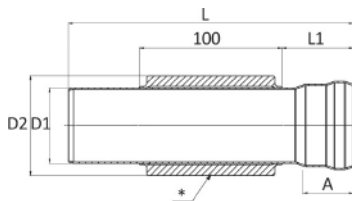

CODE	DN	D1 mm	L mm	L1 mm	D2 mm	A mm	kg		€
823040004	40	42	180	40	61	30	1,195	1	102,07
823050004	50	53	200	50	70	38	1,320	1	144,27
823065004	65	73	230	65	88,9	55	1,820	1	155,46
823080004	80	88,9	240	70	110	60	2,835	1	177,24
823100004	100	102	260	80	121	70	2,895	1	208,88
823125004	125	133	270	85	150	75	3,462	1	261,05
823150004	150	159	280	90	178	80	4,675	1	361,43

**B 100 102**

## 824/G

### FLESSIBILE PER SCARICHI / GRAVITÀ

- FLEXIBLE PIPE FOR DRAINS / GRAVITY
- FLEXIBEL ROHR / SCHWERKRAFT
- TUYAU FLEXIBLE / GRAVITÉ
- TUBO FLEXIBLE / GRAVITACIÓN

**MATERIAL:** AISI 316L – 1.4404  
**GASKET:** EPDM cod. 826/GV (Ø 50)  
**NORM:** EN 1124-3

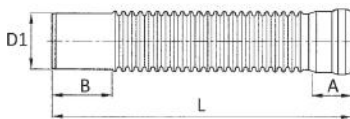

CODE	DN	D1 mm	A mm	L mm	B mm	kg		€
8240500600	50	53	38	600	55	0,780	1	391,39
8240500750	50	53	38	750	55	0,960	1	430,81
8240501000	50	53	38	1000	55	1,260	1	481,39
8240501250	50	53	38	1250	55	1,550	1	532,76

**B 100 102**

## 824/V

### FLESSIBILE PER SCARICHI / VUOTO

- FLEXIBLE PIPE FOR DRAINS / VACUUM
- FLEXIBEL ROHR / VAKUUM
- TUYAU FLEXIBLE / VIDE
- TUBO FLEXIBLE / VACÍO

**MATERIAL:** AISI 316L – 1.4404  
**GASKET:** EPDM cod. 826/GV (Ø 50)  
**NORM:** EN 1124-3

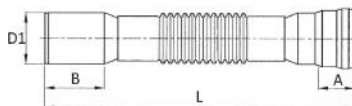



CODE	DN	D1 mm	A mm	L mm	B mm	kg		€
8240501100	50	53	38	1100	62	1,936	1	607,43
8240501500	50	53	38	1500	62	2,576	1	703,11
8240502000	50	53	38	2000	62	3,446	1	824,60
8240502500	50	53	38	2500	62	4,308	1	908,91

B 100 102

**825/01****POZZETTO CON FLANGIA / ATTACCO ORIZZONTALE**

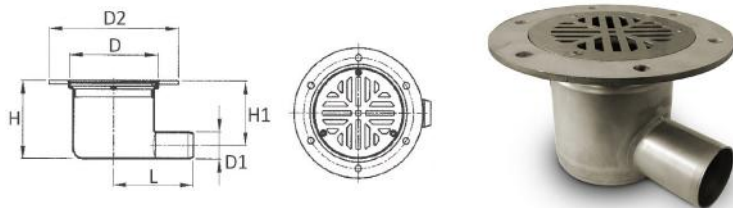
- SCUPPER WITH FLANGE / HORIZONTAL OUTLET
- BODENABLAUF MIT FLANSCH / HORIZONTAL ABGANG
- BONDE AVEC BRIDE / LATÉRAL
- DESAGÜE CON BRIDA / LATERAL

**MATERIAL:** AISI 316L - 1.4404**NOTE:** Senza sifone - Without siphon - Ohne Syphon - Sans siphon - Sin sifón



CODE	DN	D1 mm	L mm	H mm	H1 mm	D mm	D2 mm			€
825040011	40	42	115	134,5	111,5	138	200	3,280	1	464,56
825050011	50	53	115	134,5	111,5	138	200	3,300	1	470,54
825065011	65	73	142,5	134,5	99	138	200	3,420	1	477,49

B 100 102

**825/02****POZZETTO A SALDARE / ATTACCO ORIZZONTALE**

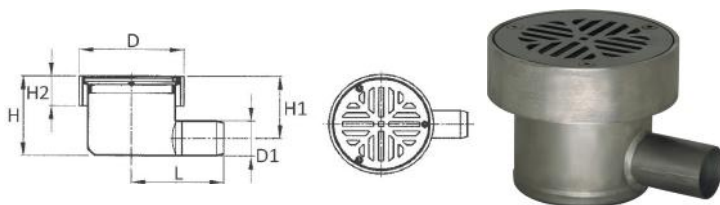
- SCUPPER TO WELD / HORIZONTAL OUTLET
- BODENABLAUF ZU SCHWEISSEN / HORIZONTAL ABGANG
- BONDE À SOUDER / LATÉRAL
- DESAGÜE PARA SOLDAR / LATERAL

**MATERIAL:** AISI 316L - 1.4404**NOTE:** Senza sifone - Without siphon - Ohne Syphon - Sans siphon - Sin sifón



CODE	DN	D1 mm	L mm	H mm	H1 mm	H2 mm	D mm			€
825040022	40	42	115	134,5	111,5	45	150	2,350	1	371,39
825050022	50	53	115	134,5	111,5	45	150	2,380	1	376,04
825065022	65	73	142,5	134,5	99	45	150	2,500	1	381,99
825100022	100	102	157,5	153,5	102,5	45	150	2,830	1	480,99

B 100 102

**825/03****POZZETTO CON FLANGIA / ATTACCO VERTICALE**

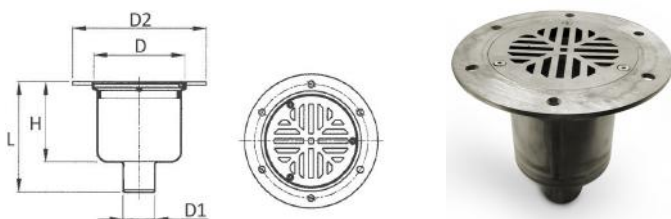
- SCUPPER WITH FLANGE / VERTICAL OUTLET
- BODENABLAUF MIT FLANSCH / VERTIKAL ABGANG
- BONDE AVEC BRIDE / VERTICAL
- DESAGÜE CON BRIDA / VERTICAL

**MATERIAL:** AISI 316L - 1.4404**NOTE:** Senza sifone - Without siphon - Ohne Syphon - Sans siphon - Sin sifón

CODE	DN	D1 mm	L mm	H mm	D mm	D2 mm			€
825040033	40	42	189,5	134,5	138	200	3,270	1	464,56
825050033	50	53	189,5	134,5	138	200	3,270	1	470,54
825065033	65	73	208,5	134,5	138	200	3,380	1	477,49

**B 100 102**

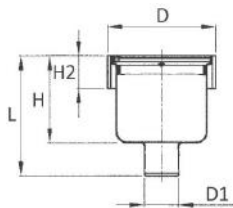

**825/04**

**POZZETTO A SALDARE / ATTACCO VERTICALE**

- SCUPPER TO WELD / VERTICAL OUTLET
- BODENABLAUF ZU SCHWEISSEN / VERTIKAL ABGANG
- BONDE À SOUDER / VERTICAL
- DESAGÜE PARA SOLDAR / VERTICAL

**MATERIAL:** AISI 316L - 1.4404  
**NOTE:** Senza sifone - Without siphon - Ohne Syphon - Sans siphon - Sin sifón

CODE	DN	D1 mm	L mm	H mm	H2 mm	D mm	kg		€
825040044	40	42	189,5	134,5	45	150	2,340	1	371,39
825050044	50	53	189,5	134,5	45	150	2,370	1	376,04
825065044	65	73	208,5	134,5	45	150	2,460	1	381,99
825100044	100	102	223,5	134,5	45	150	2,480	1	480,99

**B 100 102**

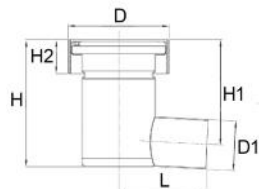

**825/05**

**POZZETTO A SALDARE / ATTACCO ORIZZONTALE / LUNGO**

- SCUPPER TO WELD / HORIZONTAL OUTLET / LONG
- BODENABLAUF ZU SCHWEISSEN / HORIZONTAL ABGANG / LANG
- BONDE À SOUDER / LATÉRAL / LONG
- DESAGÜE PARA SOLDAR / LATERAL / LARGO

**MATERIAL:** AISI 316L - 1.4404  
**NOTE:** Senza sifone - Without siphon - Ohne Syphon - Sans siphon - Sin sifón

CODE	DN	D1 mm	L mm	H mm	H1 mm	H2 mm	D mm	kg		€
825040055	40	42	128,5	187	169,5	50	150	2,006	1	561,22
825050055	50	53	129	187	164	50	150	2,032	1	587,88
825065055	65	73	129,5	187	154	50	150	2,074	1	656,95
825100055	100	102	157	187	141	50	150	2,246	1	810,39

**B 100 102**

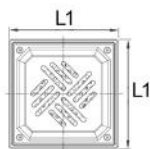
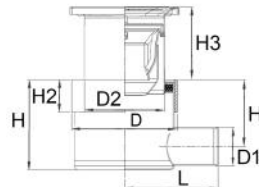

**825/06 Q**

**POZZETTO A SALDARE / ATTACCO ORIZZONTALE / TELESCOPICO / QUADRO**

- SCUPPER TO WELD / HORIZONTAL OUTLET / TELESCOPIC / SQUARE
- BODENABLAUF ZU SCHWEISSEN / HORIZONTAL ABGANG / TELESKOPISCH / QUADRAT
- BONDE À SOUDER / LATÉRAL / TÉLESCOPIQUE / CARRÉ
- DESAGÜE PARA SOLDAR / LATERAL / TELESCÓPICO / CUADRADO

**MATERIAL:** AISI 316L - 1.4404  
**NOTE:** Con sifone - With siphon - Mit Syphon - Avec siphon - Con sifón

CODE	DN	D1 mm	L mm	L1 mm	H mm	H1 mm	H2 mm	H3 mm	D mm	D2 mm	kg		€
825040066Q	40	42	128,5	150	124,5	92	45	20-100	145	110	2,946	1	1243,14
825050066Q	50	53	128,5	150	124,5	92	45	20-100	145	110	2,942	1	1259,08
825065066Q	65	73	140	150	124,5	88	45	20-100	145	110	2,992	1	1306,98

B 100 102

**825/06 C****POZZETTO A SALDARE / ATTACCO ORIZZONTALE / TELESCOPICO / ROTONDO**

- SCUPPER TO WELD / HORIZONTAL OUTLET / TELESCOPIC / ROUND
- BODENABLAUF ZU SCHWEISSEN / HORIZONTAL ABGANG / TELESKOPISCH / RUNDE
- BONDE À SOUDER / LATÉRAL / TÉLESCOPIQUE / ROND
- DESAGÜE PARA SOLDAR / LATERAL / TELESCÓPICO / REDONDO

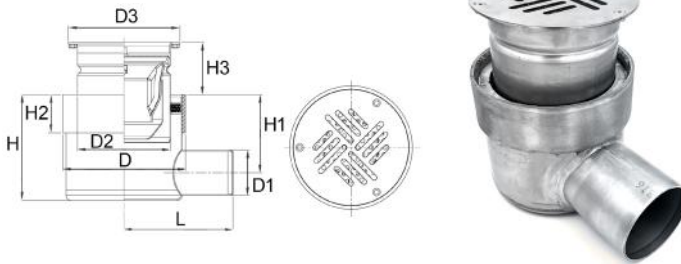
**MATERIAL:** AISI 316L - 1.4404**NOTE:** Con sifone - With siphon - Mit Syphon - Avec siphon - Con sifón

CODE	DN	D1 mm	L mm	H mm	H1 mm	H2 mm	H3 mm	D mm	D2 mm	D3 mm	kg	€
825040066C	40	42	128,5	124,5	92	45	25-90	145	110	136	2,782	1243,14
825050066C	50	53	128,5	124,5	92	45	25-90	145	110	136	2,838	1259,08
825065066C	65	73	140	124,5	88	45	25-90	145	110	136	2,865	1306,98

B 100 102

**825/07 Q****POZZETTO A SALDARE / ATTACCO VERTICALE / TELESCOPICO / QUADRO**

- SCUPPER TO WELD / VERTICAL OUTLET / TELESCOPIC / SQUARE
- BODENABLAUF ZU SCHWEISSEN / VERTIKAL ABGANG / TELESKOPISCH / QUADRAT
- BONDE À SOUDER / VERTICAL / TÉLESCOPIQUE / CARRÉ
- DESAGÜE PARA SOLDAR / VERTICAL / TELESCÓPICO / CUADRADO

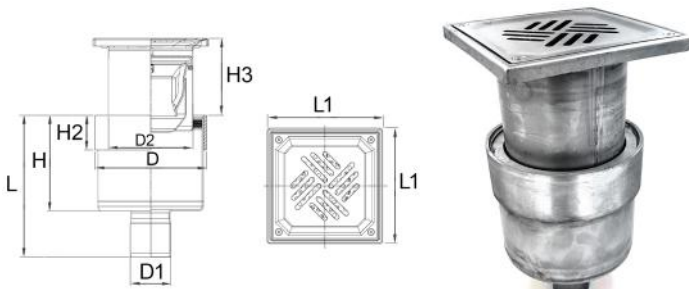
**MATERIAL:** AISI 316L - 1.4404**NOTE:** Con sifone - With siphon - Mit Syphon - Avec siphon - Con sifón

CODE	DN	D1 mm	L mm	L1 mm	H mm	H2 mm	H3 mm	D mm	D2 mm	kg	€
825040077Q	40	42	184,5	150	124,5	45	20-100	145	110	2,904	1179,27
825050077Q	50	53	184,5	150	124,5	45	20-100	145	110	2,950	1199,22
825065077Q	65	73	198,5	150	124,5	45	20-100	145	110	2,980	1243,14

B 100 102

**825/07 C****POZZETTO A SALDARE / ATTACCO VERTICALE / TELESCOPICO / ROTONDO**

- SCUPPER TO WELD / VERTICAL OUTLET / TELESCOPIC / ROUND
- BODENABLAUF ZU SCHWEISSEN / VERTIKAL ABGANG / TELESKOPISCH / RUNDE
- BONDE À SOUDER / VERTICAL / TÉLESCOPIQUE / ROND
- DESAGÜE PARA SOLDAR / VERTICAL / TELESCÓPICO / REDONDO

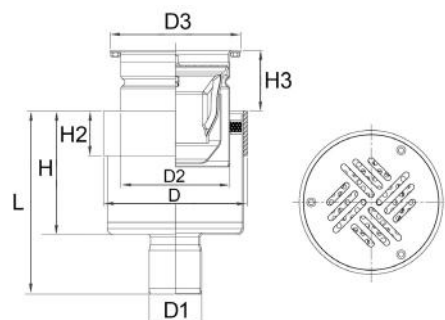
**MATERIAL:** AISI 316L - 1.4404**NOTE:** Con sifone - With siphon - Mit Syphon - Avec siphon - Con sifón

CODE	DN	D1 mm	L mm	H mm	H2 mm	H3 mm	D mm	D2 mm	D3 mm	kg	€
825040077C	40	42	184,5	124,5	45	25-90	145	110	136	2,817	1179,27
825050077C	50	53	184,5	124,5	45	25-90	145	110	136	2,798	1199,22
825065077C	65	73	198,5	124,5	45	25-90	145	110	136	2,848	1243,14

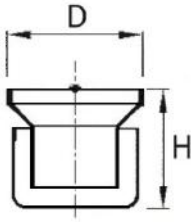
**820/P**
**B 100 102**
**SIFONE PER POZZETTO DI SCARICO**

- SIPHON FOR SCUPPER DRAIN
- SIPHON FÜR BODENABLAUF
- SIPHON POUR BONDE
- SIFÓN PARA DESAGÜE

**MATERIAL:** AISI 316L – 1.4404

**NOTE:** per / for / für / pour / para 825/01÷04



CODE	D mm	H mm	kg		€
82000000	106	96	0,365	1	125,35

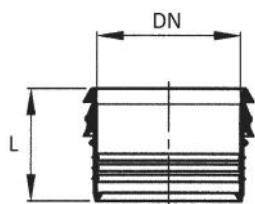

**826/GV****B 100 102****ANELLO DI TENUTA / GRAVITÀ + VUOTO**

- SEAL / GRAVITY + VACUUM
- DICHTUNG / SCHWERKRAFT + VAKUUM
- JOINT / GRAVITÉ + VIDE
- GUARNICIÓN / GRAVITACIÓN + VACÍO

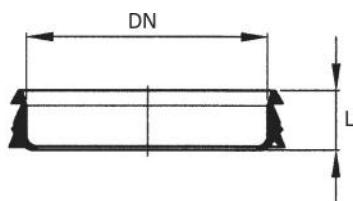

**MATERIAL:** gomma / rubber EPDM

CODE	DN	L mm			€
826040000	40	34,5	0,010	1	2,22
826050000	50	42,5	0,018	1	2,69
826065000	65	59,5	0,035	1	4,42

**826/G****B 100 102****ANELLO DI TENUTA**

- SEAL
- DICHTUNG
- JOINT
- GUARNICIÓN

**MATERIAL:** gomma / rubber EPDM



CODE		DN	L mm			€
826040001	*	40	15	0,007	1	1,88
826050001	*	50	18	0,012	1	2,32
826065001	*	65	21	0,020	1	3,31
826080001	**	80	22,5	0,029	1	3,34
826100001	**	100	27	0,051	1	3,65
826125001	**	125	29,5	0,080	1	5,71
826150001	**	150	36	0,138	1	7,54

[\*] gravità / gravity / Schwerrkraft / gravité / gravitación

[\*\*] gravità + test a vuoto fino a -0,97 bar / gravity + vacuum tested up to -0,97 bar / Schwerrkraft + Vakuumgeprüft bis -0,97 bar / gravité + testé sous vide à -0,97 bar / gravitación + prueba de vacío a -0,97 bar

**826/L****B 100 102****TUBETTO LUBRIFICANTE 150 GR**

- LUBRICANT 150 GR
- SCHMIERSTOFF 150 GR
- LUBRIFIANT 150 GR
- LUBRICANTE 150 GR

CODE				€
826000002	0,150	1	24	5,81

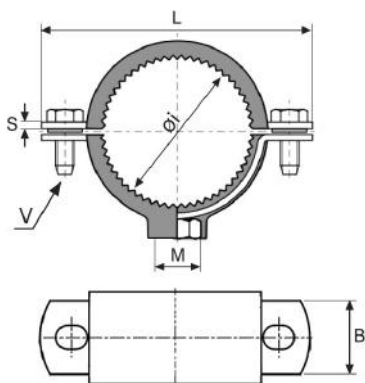
**A 50 50**

 Conforme a  
 Conform to  
 Entsprechend  
 Correspondant  
 Conforme a la

**DIN 4109**
**156/G**
**COLLARE CON GOMMA**

- CLAMP WITH RUBBER
- ROHRSCHELLE MIT GUMMIEINLAGE
- COLLIER DE FIXATION GARNITURE ISOPHONIQUE
- ABRAZADERA ISOFÓNICA

**MATERIAL:** AISI 304 - 1.4301

**VULCANIZED RUBBER:** EPDM (-20° C/+120° C)  
 durezza/hardness 55 Shore

**NOTE:** dado saldato con puntatura elettrica  
 spot welded nut

CODE	Øi Drain mm	M	V mm	B mm	L mm	S mm				€
<b>156114304G</b>	42	M 8	M 6 x 20	20	85	2,5	120	1	50*	<b>15,09</b>
<b>156112304G</b>	53	M 8	M 6 x 25	20	97	2,5	142	1	50*	<b>16,45</b>
<b>156212304G</b>	73	M 10	M 6 x 25	30	128	2,5	308	1	10*	<b>24,98</b>
<b>156300304G</b>	88,9	M 10	M 6 x 25	30	148	2,5	346	1	10*	<b>27,07</b>

[\*] unità minima di vendita / minimum selling quantity

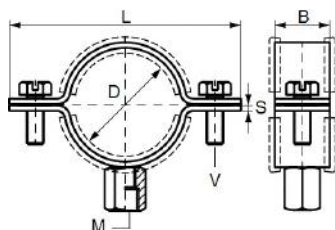
**A 50 51**

**156/G**
**COLLARE CON GOMMA**

- CLAMP WITH RUBBER
- ROHRSCHELLE MIT GUMMIEINLAGE
- COLLIER DE FIXATION GARNITURE ISOPHONIQUE
- ABRAZADERA ISOFÓNICA

**MATERIAL:** AISI 316 - 1.4401

**VULCANIZED RUBBER:** EPDM (-20° C/+120° C)

**NOTE:** dado saldato con puntatura elettrica  
 spot welded nut

CODE	Øi Drain mm	DN inch	M	V mm	B mm	L mm	S mm			€
<b>156312316G</b>	102	3"1/2	M 8 / 10	M 6 x 20	20	165	2	189	10*	<b>22,60</b>
<b>156500316G</b> **	133	5"	M 10	M 6 x 25	20	179	2,5	250	10*	<b>28,05</b>
<b>156600316G</b> **	159	6"	M 10	M 8 x 35	25	233	2,5	470	10*	<b>30,75</b>

[\*] unità minima di vendita / minimum selling quantity

[\*\*] AISI 316L / 1.4404